

**Land Grant Map**  
 Mount Olive Quadrangle  
 Duplin and Wayne Counties, North Carolina

Researched and drawn by Thomas M. Byrd  
 907 Washington Street, Cary, NC 27511  
 (919) 487-9848 tmb@landmail.com

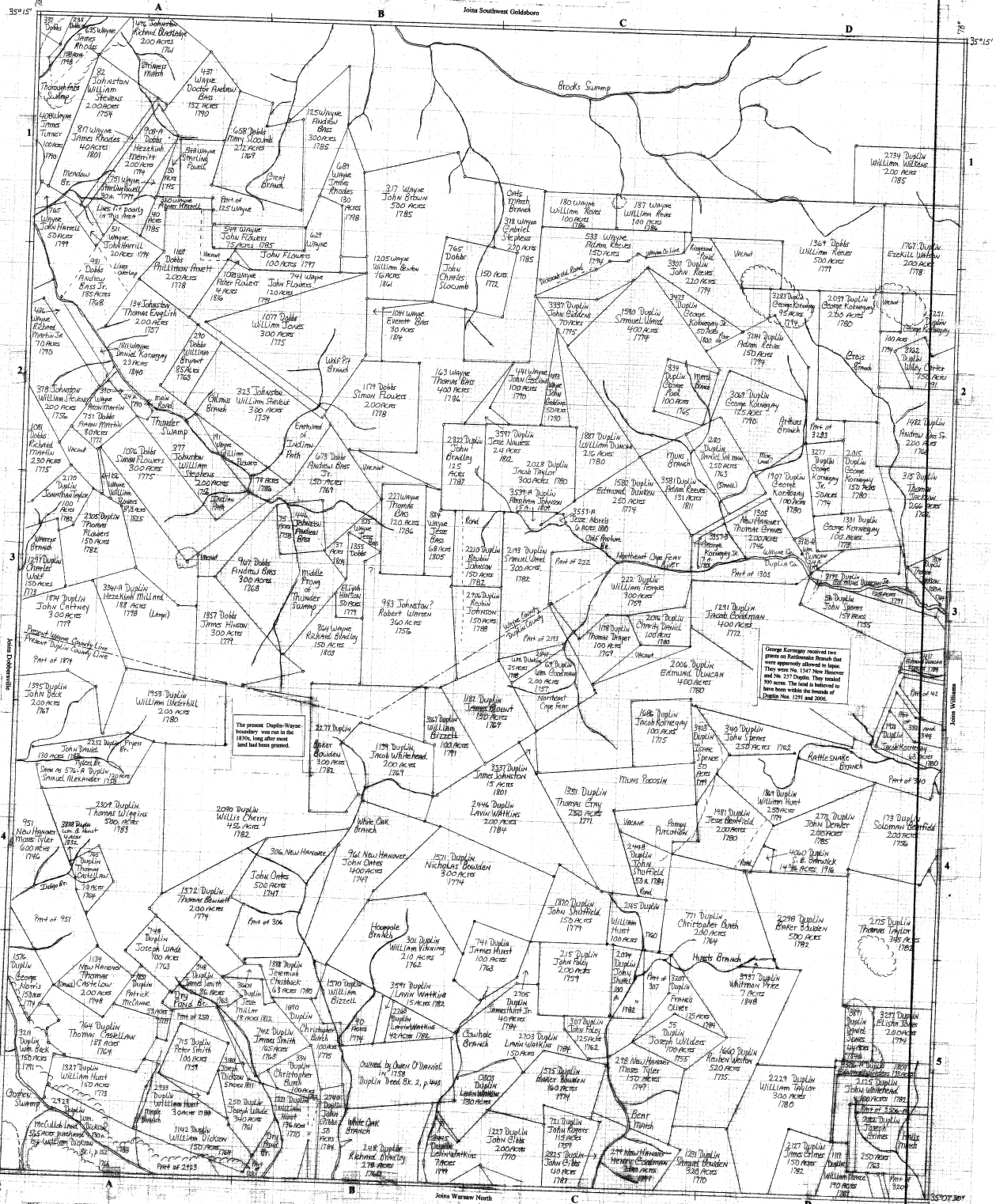

Written on most plats are five bits of information: the file number for the grant, the county under which the grant was issued, the name of the grantee, the acreage, and the year the grant was issued. Deed books are cited in cases where grants have not been found or where the boundaries of grants cannot be determined.

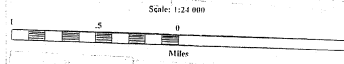

Information used in constructing this map came mainly from land grant records in the North Carolina Department of Archives and History in Raleigh and from Duplin and Georgetown County deed books. The location of waterways was determined from a U. S. Geological Survey map for a quadrangle of the same name. Names shown for the waterways were taken from land grants, not from the USGS map.