

Land Grant Map
Lyman Quadrangle
Duplin and Onslow Counties, North Carolina

Revised and drawn by Thomas M. Byrd,
908 Washington Street, Cary, NC 27511
(919) 467-2848 byrdt@aol.com

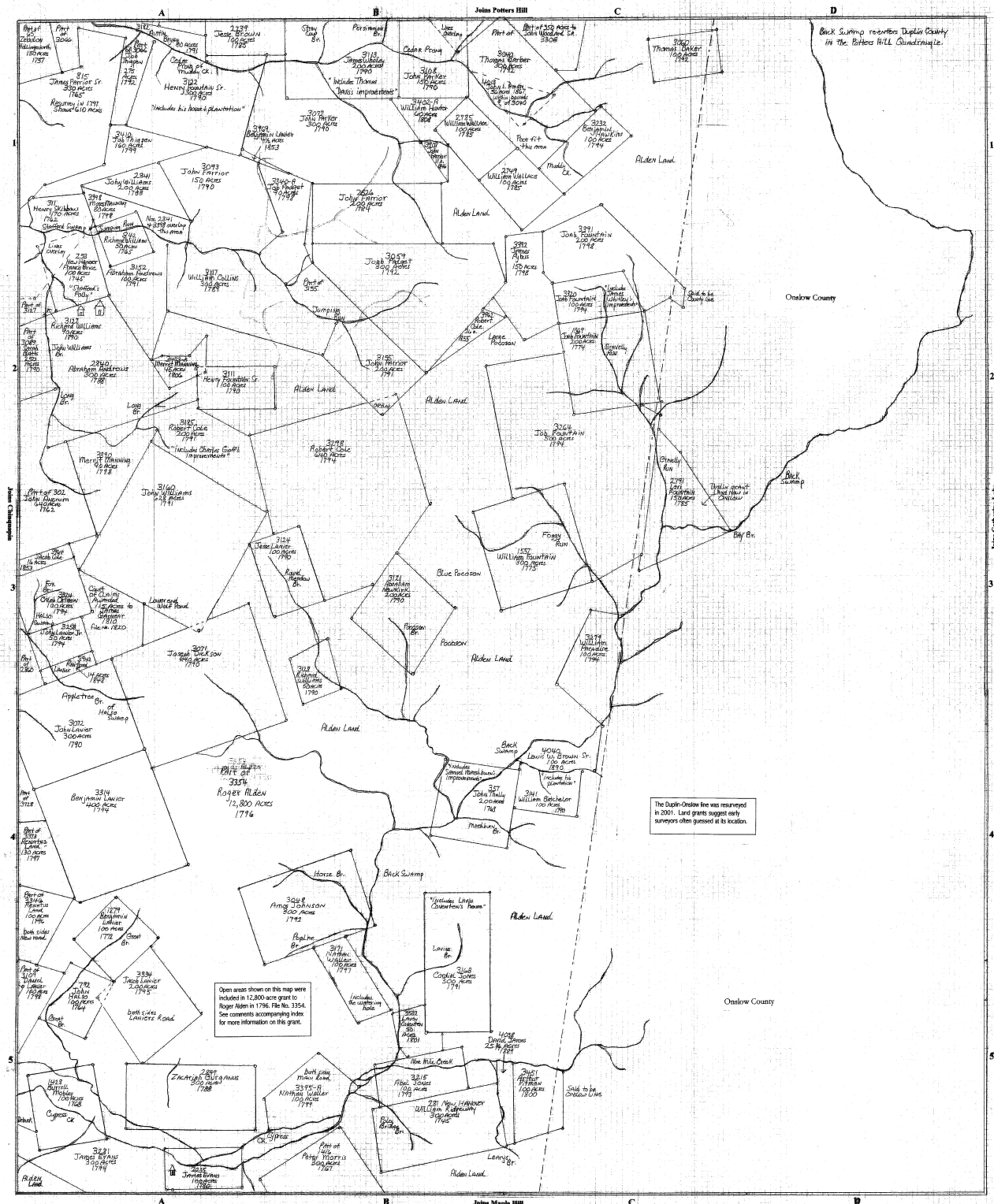

Written on most plats are five bits of information: (1) the file number of the grant, (2) the county under which the grant was issued, (3) the name of the grantee, (4) the acreage, and (5) the year in which the grant was issued. If an county is given, the grant was issued in the name of the county in which the land is currently located. Deed books are cited to show ownership where grants have not been found or information in the grants is incomplete.



Information used in constructing this map came mainly from land grant records in the North Carolina Department of Archives and History in Raleigh and from deed and map books in the Duplin County Register of Deeds Office in Kamosville. The location of waterways was determined from a U. S. Geological Survey map for a quadrangle of the same name. Names shown for the waterways were taken from the land grants and not from the USGS map. References to roads, houses, and other places shown on this map were also taken from the grants.