

Land Grant Map
Warsaw South Quadrangle
Duplin County, North Carolina

Researched and drawn by Thomas M. Byrd
903 Washington Street, Cary, NC 27511
(919) 467-9848 byrdjtm@aol.com

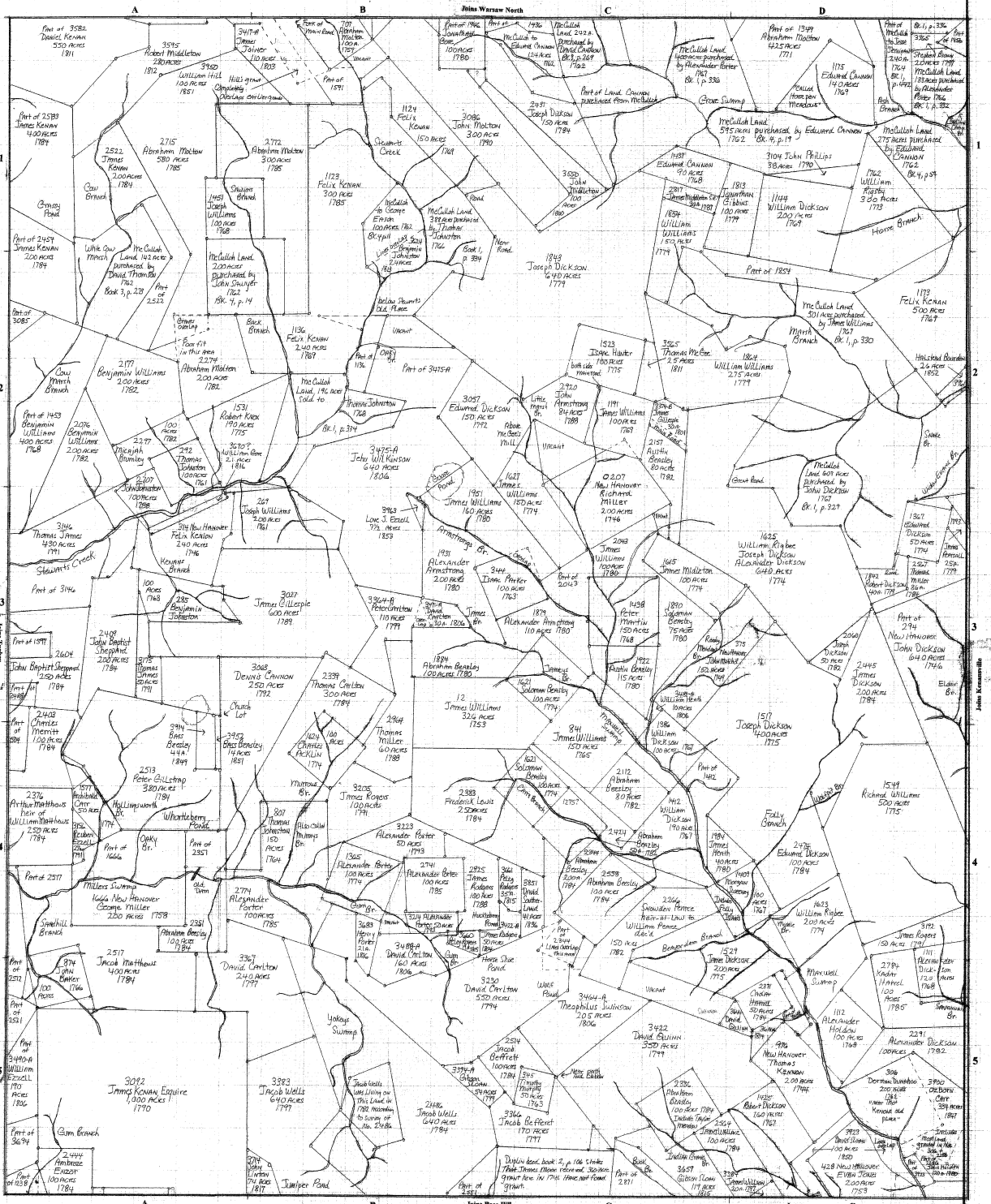

Written on most plats are five bits of information: (1) the file number of the grant, (2) the county under which the grant was issued, (3) the name of the grantee, (4) the acreage, and (5) the year in which the grant was issued. If no county is given, the grant was issued in the name of the county in which the land is currently located. Deed books are cited to show ownership where grants have not been found or where information on the grants is incomplete.

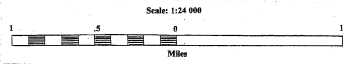

Information used in constructing this map came mainly from land grant records in the North Carolina Department of Archives and History in Raleigh and from Duplin and Sampson County deed books. The location of watersheds was determined from a U.S. Geological Survey map for a quadrangle of the same name. Names shown for the watersheds were taken from the land grants and not from the USGS map. References to roads, houses, and other places shown on the map were also taken from the grants.