

**Land Grant Map**  
**Albertson Quadrangle**  
 Duplin and Lenoir Counties, North Carolina

Researched and drawn by Thomas M. Byrd,  
 903 Washington Street, Cary, NC 27511  
 (919) 467-0848. byrd@land.com

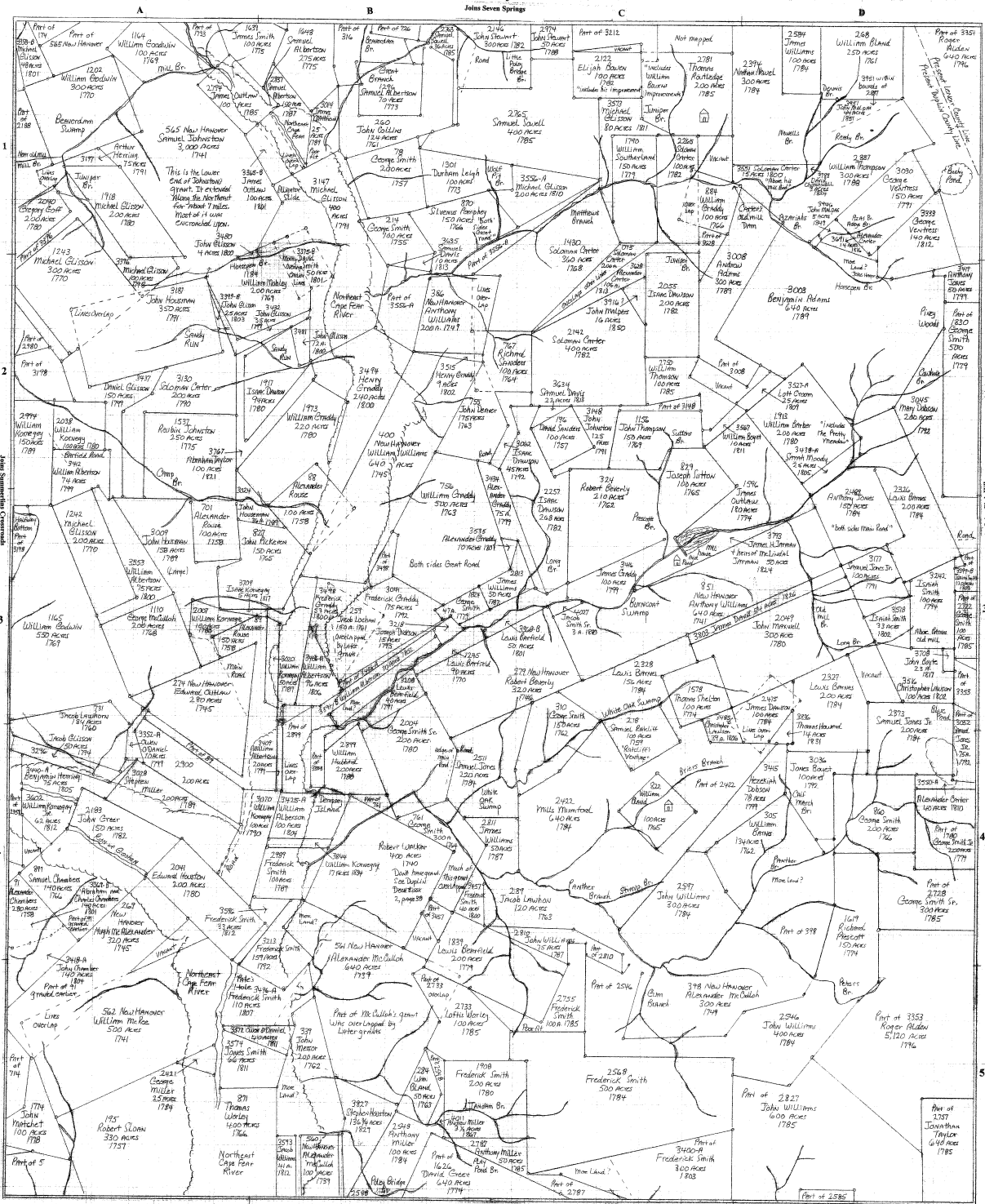

Written on most plots are five bits of information: (1) the file number of the grant, (2) the county under which the grant was issued, (3) the name of the grantee, (4) the acreage, and (5) the year in which the grant was issued. If no county is given, the grant was issued in the name of the county in which the land is currently located. Dead books are cited to show ownership where grants have not been found or information in the grants is incomplete.

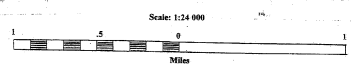

Information used in constructing this map came mainly from land grant records in the North Carolina Department of Archives and History in Raleigh and from Duplin and Sampson County deed books. The location of waterways was determined from a U.S. Geological Survey map for a quarter-mile of the same name. Names shown for the waterways were taken from the land grants and not from the USGS map. References to roads, houses, and other places shown on this map were also taken from the grants.